

Located on Lower Level Below Main Lobby

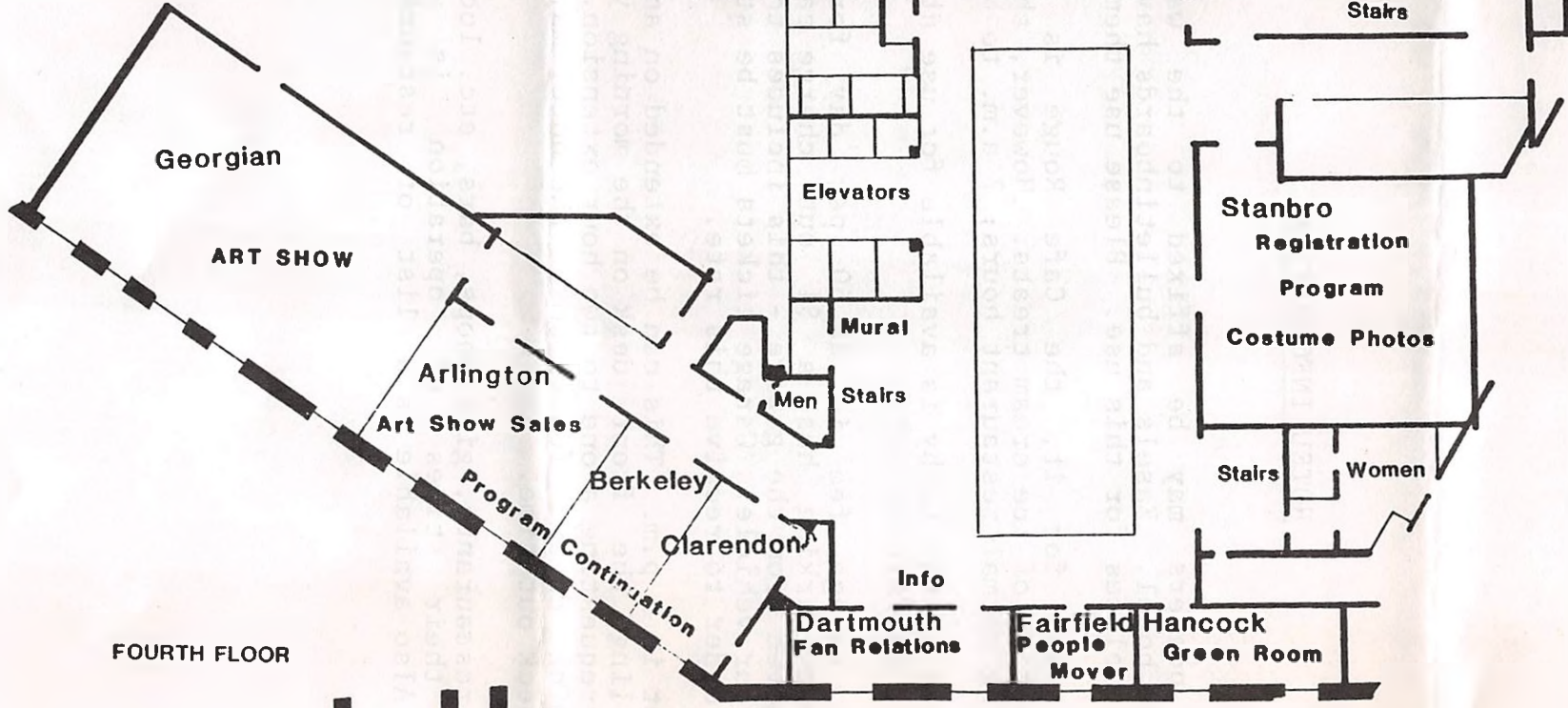

FOURTH FLOOR

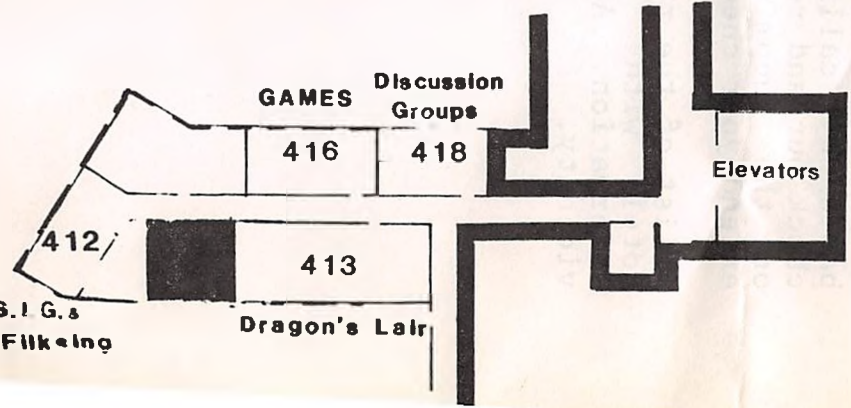

BOSKONE XIX

HOTEL INFORMATION

No signs or posters may be affixed to the walls or other surfaces of the hotel. Easels and bulletinboards have been set up in strategic places for this use. Please use them.

Because you asked for it, the Cafe Rouge is offering an extensive selection of ice cream treats. However, they are only available during normal restaurant hours; 7 a.m. to Midnight.

The Check Room in the Lobby is available for use at any time by asking the Bell Captain on duty.

Maximum hotel garage fee is \$6.50 per day for non-guest parking. Guest parking has a \$1 out charge each time your vehicle is removed from the garage - this includes the last time you remove your vehicle. Garage tickets must be stamped at the hotel desk in order to receive this rate.

Hotel check out is 1 p.m. This can be extended on an individual basis by calling the front desk on the morning you intend to check out and requesting a one to two hour extension. Depending on the incoming demand for rooms, the hotel may be happy to extend your check out time.

A list of the restaurants, gift shops, bars, etc. located in the hotel with their times of operation is available at Information. Also available is a list of restaurants in the vicinity.